

An aerial photograph of Gatwick Airport's northern runway and taxiway. The runway is a long, straight concrete strip with white markings, including the number '26' and the letter 'L'. Several aircraft are visible on the taxiway and runway. In the foreground, a large white Airbus A380 is taxiing. To its left, a smaller white aircraft is also taxiing. Further up the runway, another white aircraft is visible. In the bottom left corner, a red and white easyJet aircraft is taxiing. The surrounding area includes green grass, paved taxiways, and airport buildings in the distance. The text 'YOUR LONDON AIRPORT' is written in white, uppercase letters, and 'Gatwick' is written in a white, cursive font below it.

YOUR LONDON AIRPORT
Gatwick

Our northern runway: making best use of Gatwick

Preliminary Environmental Information Report
Appendix 5.2.1 Highway Improvement Plans
September 2021

Table of Contents

1	Introduction	1
---	--------------	---

1 Introduction

1.1 General

1.1.1 This document forms Appendix 5.2.1 of the Preliminary Environmental Information Report (PEIR) prepared on behalf of Gatwick Airport Limited (GAL). The PEIR presents the preliminary findings of the Environmental Impact Assessment (EIA) process for the proposal to make best use of Gatwick Airport's existing runways (referred to within this report as 'the Project'). The Project proposes alterations to the existing northern runway which, together with the lifting of the current restrictions on its use, would enable dual runway operations. The Project includes the development of a range of infrastructure and facilities which, with the alterations to the northern runway, would enable the airport passenger and aircraft operations to increase. Further details regarding the components of the Project can be found in the Chapter 5: Project Description.

1.1.2 This document provides the highway improvement plans for the Project.

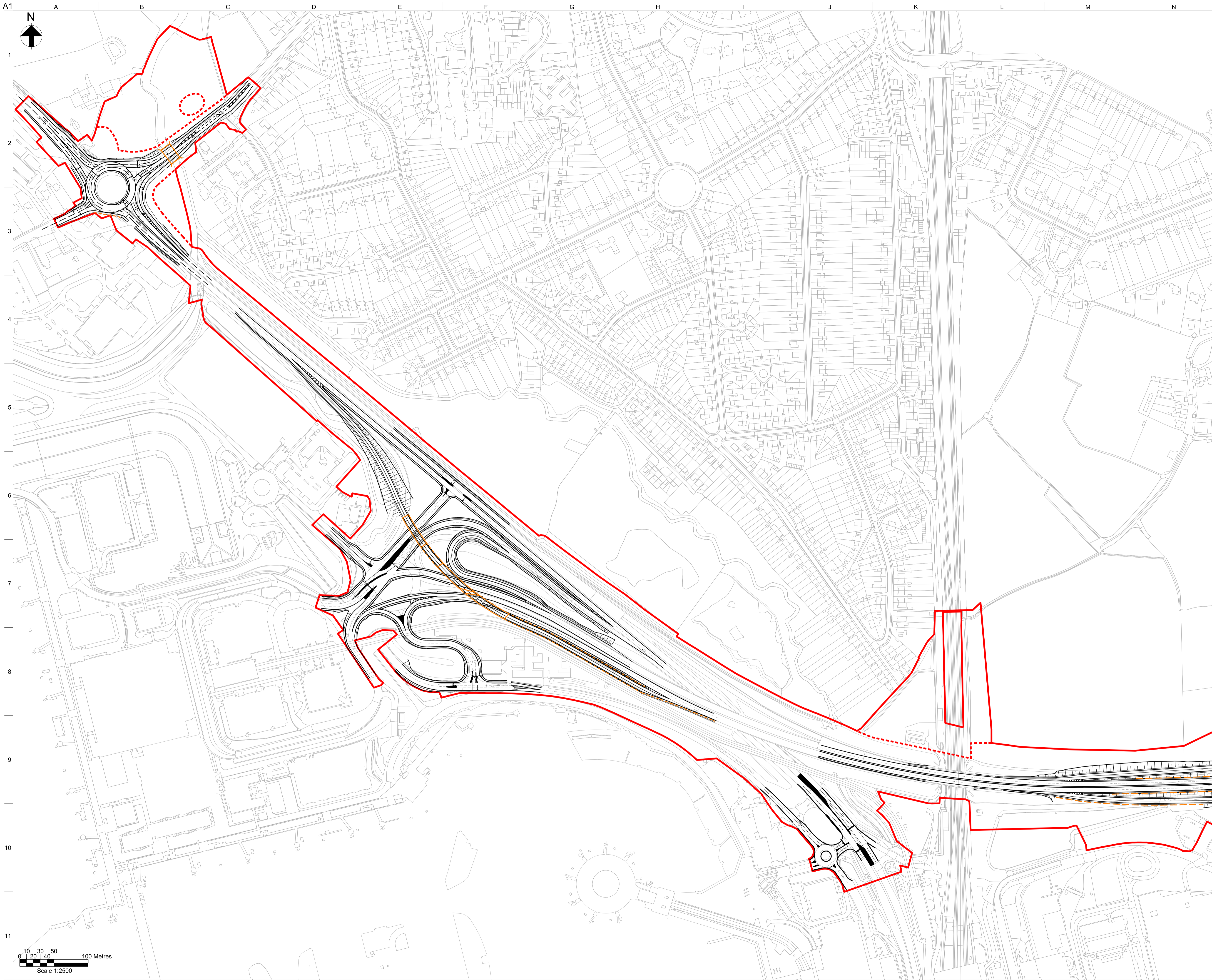

- Legend**
- Proposed Red Line Boundary
 - - - Extent of Highway Red Line Boundary
 - Proposed Bridge Structure
 - - - Proposed Retaining Walls

---	16/08/21	NW	DA	DH
-----	----------	----	----	----

Rev	Date	By	Chkd	Appd

ARUP

Blythe Gate, Blythe Valley Park
 Tel +44 121 213 3000 Fax +44 121 213 3001

Client
Gatwick Airport Ltd
 Destinations Place
 Gatwick Airport
 West Sussex RH6 0NP

Project Title
Gatwick Airport
 Northern Runway Project
 Surface Access

Drawing Title
Highway Layout North Terminal
 Initial Indicative
 Red Line Boundary (RLB)
 Sheet 1 of 2

Scale at A1 1:2500

Role Civil - Highways

Suitability S0 - Initial non-contractual

Arup Job No **225680-84** Rev **P03.3**

Name **LGW2NR-ARP-ZZ-ZZ-DR-CH-00316**

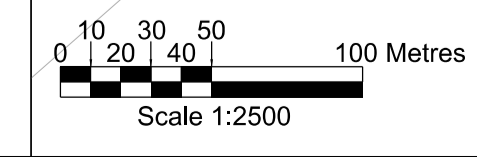

Do not scale

p:\MCCN\SI04_gatwick-arup.com\PW_ARUP_UK\Documents\LGW_Surface Access\01_Arup\CH - Civil Engineer - Highways\DR - Drawings\LGW2NR-ARP-ZZ-ZZ-DR-CH-00316

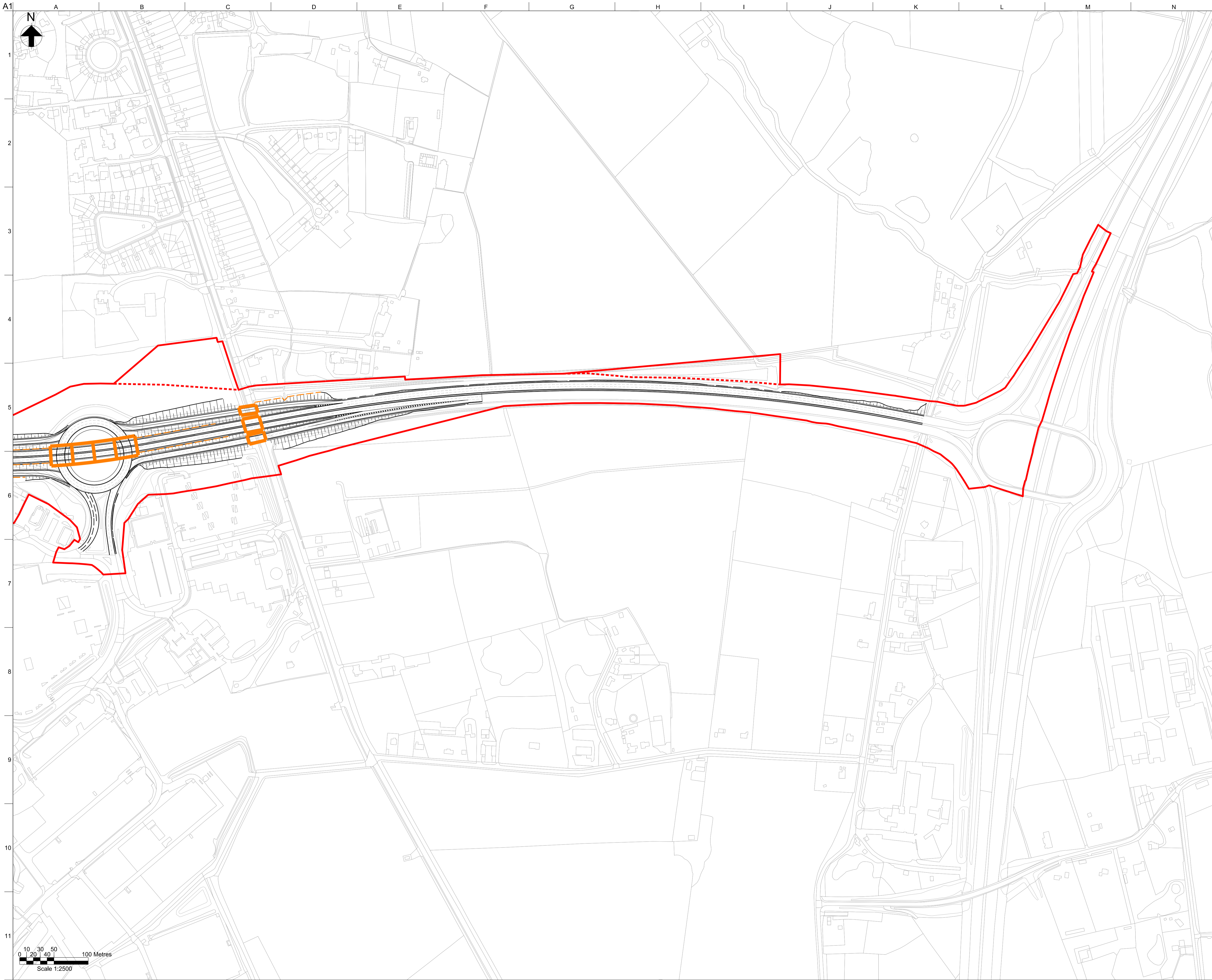

- Legend**
- Proposed Red Line Boundary
 - - - Extent of Highway Red Line Boundary
 - Proposed Bridge Structure
 - - - Proposed Retaining Walls

---	16/08/21	NW	DA	DH
-----	----------	----	----	----

Rev	Date	By	Chkd	Appd

ARUP

Blythe Gate Blythe Valley Park
 Tel +44 121 213 3000 Fax +44 121 213 3001

Client
Gatwick Airport Ltd
 Destinations Place
 Gatwick Airport
 West Sussex RH6 0NP

Project Title
Gatwick Airport
 Northern Runway Project
 Surface Access

Drawing Title
Highway Layout Southern Terminal
 Initial Indicative
 Red Line Boundary (RLB)
 Sheet 2 of 2

Scale at A1 1:2500

Role Civil - Highways

Suitability S0 - Initial non-contractual

Arup Job No 225680-84	Rev P03.3
---------------------------------	---------------------

Name
LGW2NR-ARP-ZZ-ZZ-DR-CH-00315

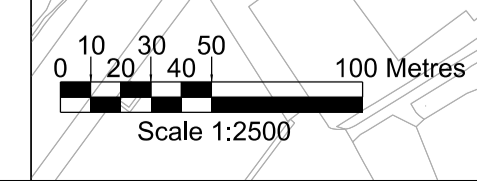

Do not scale

jw/MCCN/5104_gbat/arp.com/PW_ARUP_LWK/Document/LW_Surface Access/01_Arup/CH - Civil Engineer - Highways/DR - Drawing/LGW2NR-ARP-ZZ-ZZ-DR-CH-00315